



GRANDVIEW PLAZA



SCAN HERE!



EDDIE CHERRY, COIM

Phone: 314.647.6611 ext. 113
Eddie@ManorRealEstate.com

CALEB ANTHONIS

Phone: 314.647.6611 ext. 126
Caleb@ManorRealEstate.com

**1491 DUNN RD.
FLORISSANT, MO 63033
1,500-43,416 S.F. | \$7-15/S.F. N.N.N.**

PROPERTY INFORMATION



DEMOGRAPHICS		1 MILE	3 MILES	5 MILES
POPULATION		11,144	93,867	232,222
HOUSEHOLDS		4,666	38,334	95,180
AVERAGE HH INCOME		\$82,768	\$76,120	\$76,934

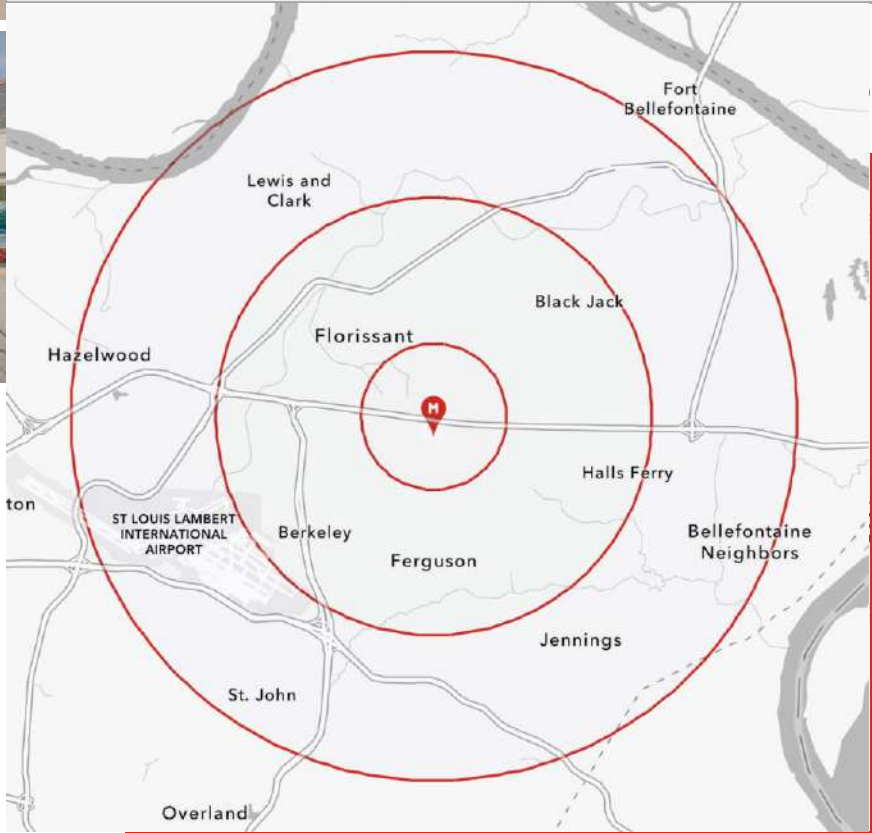

- LEASING OPPORTUNITIES AT SCHNUCK'S ANCHORED GRANDVIEW PLAZA!
- ESTABLISHED SHOPPING CENTER
- NEARLY 300,000SF OF GLA
- JOIN OLD TIME POTTERY, WALGREENS, TACO BELL, RAINBOW
- EXCELLENT VISIBILITY AND ACCESS TO I-270 (140,000+ VPD)
- ABUNDANT PARKING (1,500+ SPACES)
- PYLON SIGNAGE AVAILABLE FOR QUALIFYING TENANTS

SCAN HERE!



EDDIE CHERRY, COIM **CALEB ANTHONIS**

Phone: 314.647.6611 ext. 113
Eddie@ManorRealEstate.com

Phone: 314.647.6611 ext. 126
Caleb@ManorRealEstate.com

1491 DUNN RD.
FLORISSANT, MO 63033
1,500-43,416 S.F. | \$7-15/S.F. N.N.N.

SITE PLAN

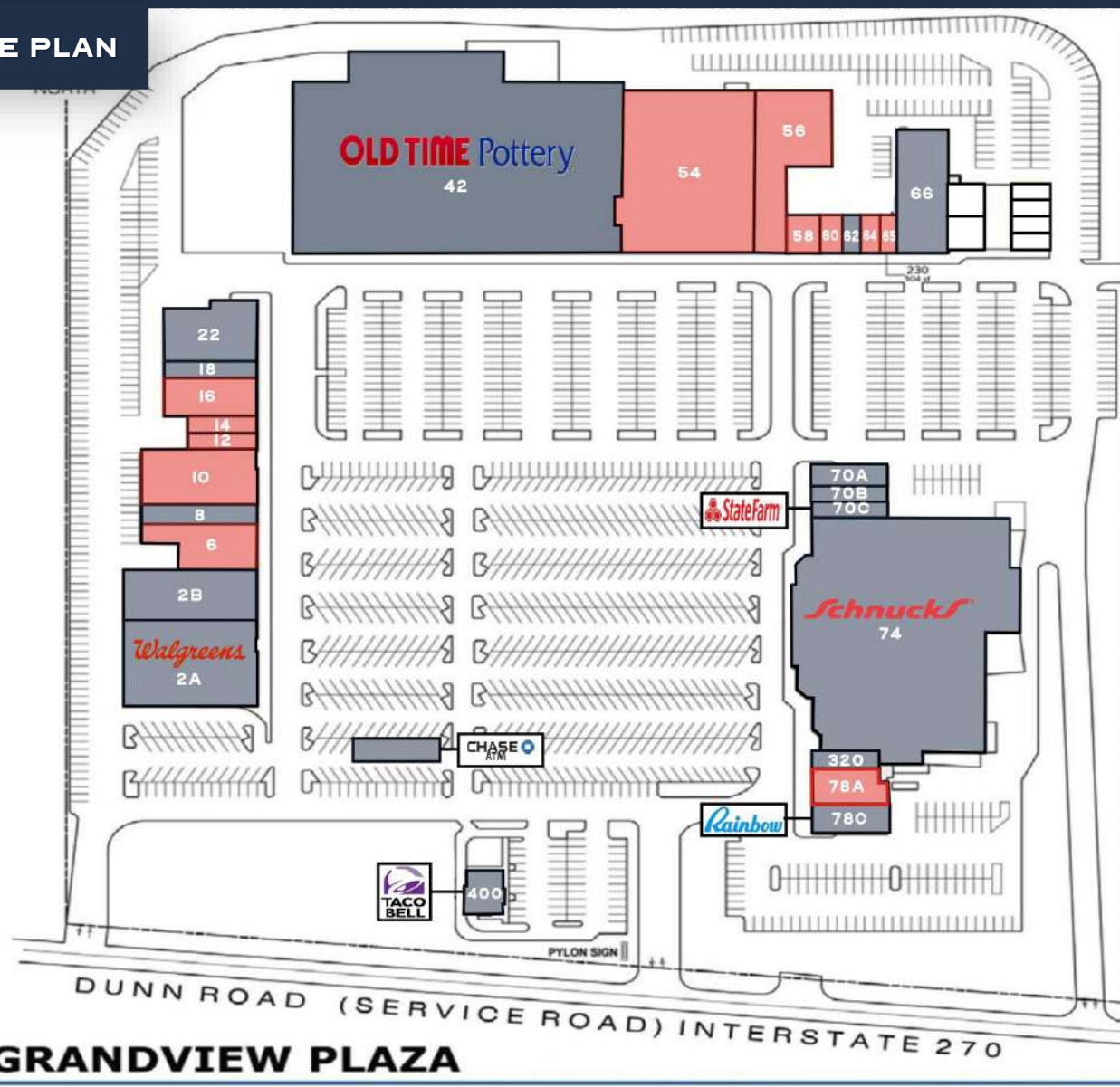

AVAILABLE SPACES

SUITE	SIZE
6	6,144 S.F.
10	9,462 S.F.
12	1,500 S.F.
14	1,875 S.F.
16	4,040 S.F.
54	30,866 S.F.
56	12,550 S.F.
58	2,000 S.F.
64	890 S.F.
65	1,104 S.F.
78A	1,440 S.F.

SCAN HERE!



EDDIE CHERRY, COIM

Phone: 314.647.6611 ext. 113
Eddie@ManorRealEstate.com

CALEB ANTHONIS

Phone: 314.647.6611 ext. 126
Caleb@ManorRealEstate.com

1491 DUNN RD.
 FLORISSANT, MO 63033
 1,500-43,416 S.F. | \$7-15/S.F. N.N.N.

AERIAL

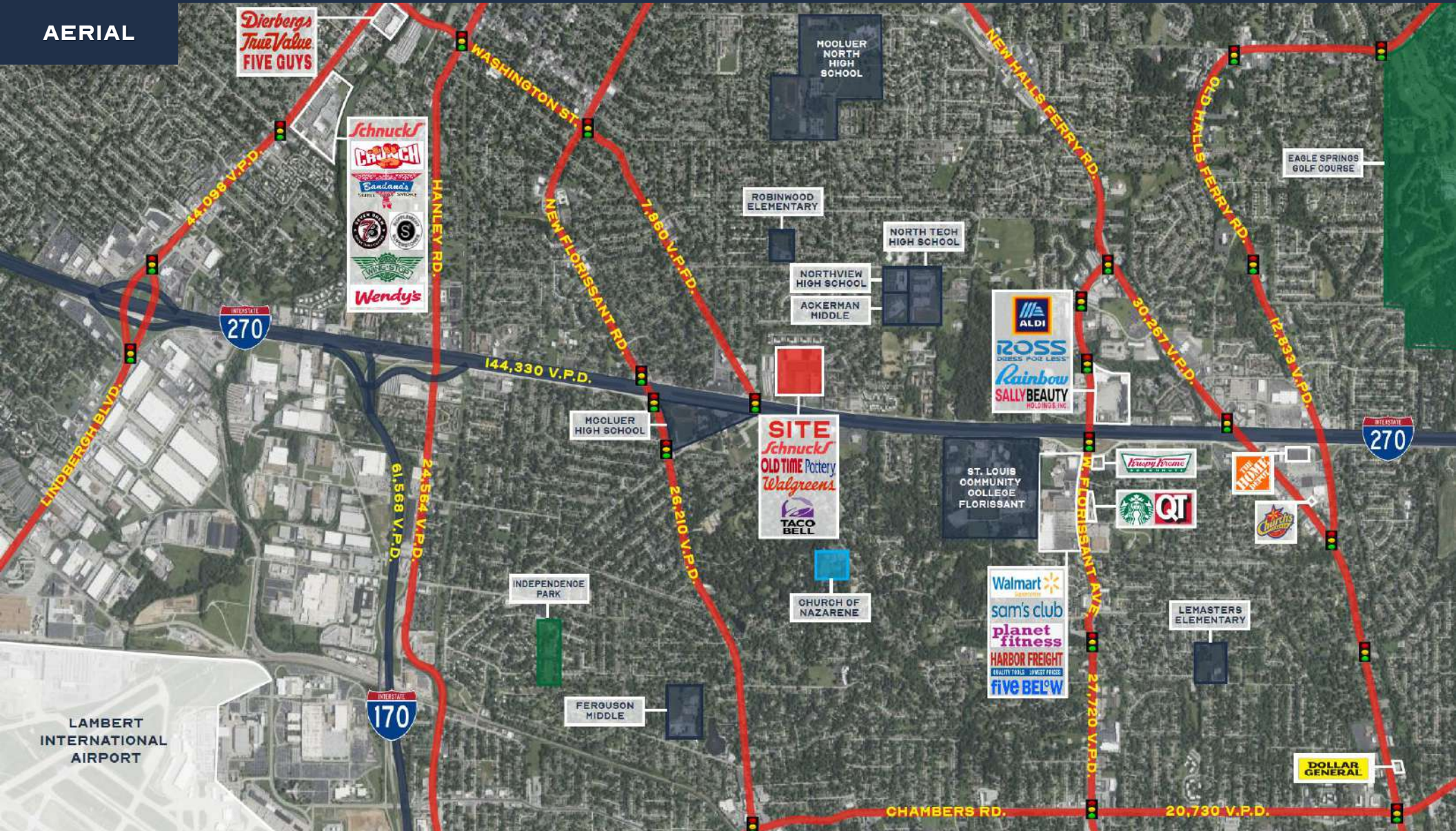

SCAN HERE!



EDDIE CHERRY, COIM

Phone: 314.647.6611 ext. 113
 Eddie@ManorRealEstate.com

CALEB ANTHONIS

Phone: 314.647.6611 ext. 126
 Caleb@ManorRealEstate.com

**1491 DUNN RD.
 FLORISSANT, MO 63033
 1,500-43,416 S.F. | \$7-15/S.F. N.N.N.**