



CREVE COEUR RETAIL BUILDING



SCAN HERE!



EDDIE CHERRY, CCIM **BEN CHERRY, CCIM**

Phone: 314.647.6611 ext. 113
Eddie@ManorRealEstate.com

Phone: 314.647.6611 ext. 115
Ben@ManorRealEstate.com

295 N. LINDBERGH BLVD.
ST. LOUIS, MO 63141
13,680 S.F. | \$2,200,000 (\$160/S.F.)
1.43 ACRES

PROPERTY INFORMATION



DEMOGRAPHICS	1 MILE	3 MILES	5 MILES
POPULATION	4,823	60,775	217,583
HOUSEHOLDS	1,818	26,011	93,438
AVERAGE HH INCOME	\$251,990	\$155,044	\$142,960

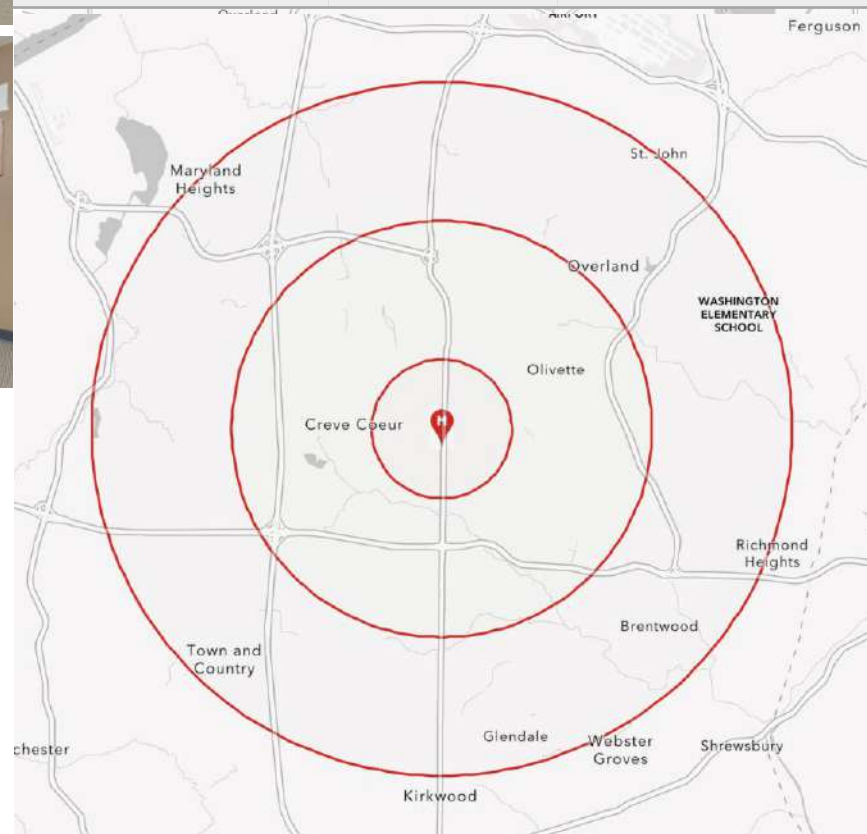

- VERSATILE 13,680 S.F. BUILDING
- EXCELLENT LINDBERGH FRONTAGE WITH 37,000+ V.P.D.
- ZONED GENERAL COMMERCIAL
- IDEAL FOR RETAIL, OFFICE AND LIGHT WAREHOUSE USES
- OVER 52 PARKING SPACES
- NEW ROOF & PARKING LOT (2020)
- SOLAR PANELS INSTALLED 2013
- CENTRALLY LOCATED BETWEEN OLIVE & I-64 ON N. LINDBERGH

SCAN HERE!



EDDIE CHERRY, CCIM **BEN CHERRY, CCIM**

Phone: 314.647.6611 ext. 113
Eddie@ManorRealEstate.com

Phone: 314.647.6611 ext. 115
Ben@ManorRealEstate.com

295 N. LINDBERGH BLVD.
ST. LOUIS, MO 63141
13,680 S.F. | \$2,200,000 (\$160/S.F.)
1.43 ACRES

FLOOR PLAN

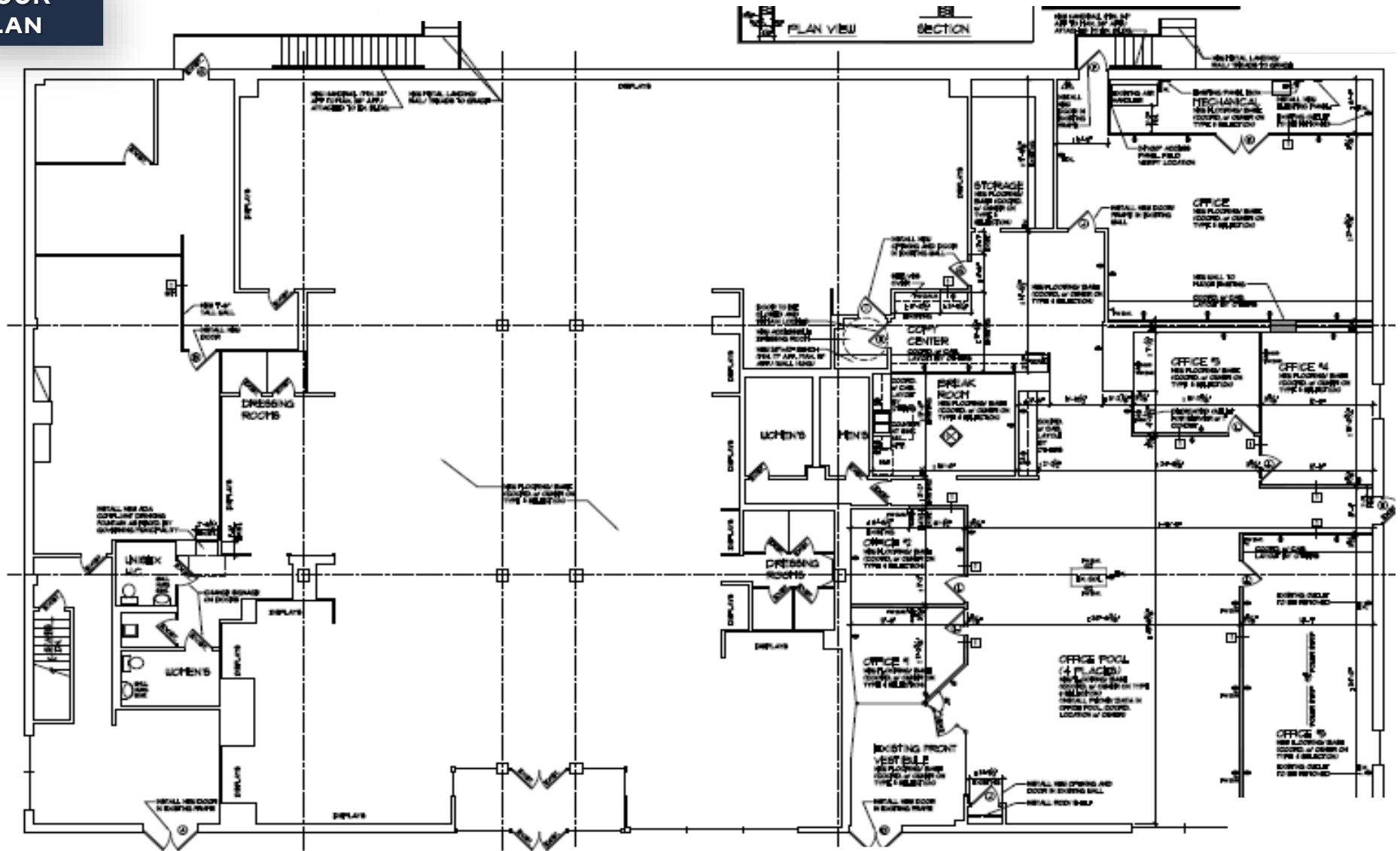

SCAN HERE!



EDDIE CHERRY, CCIM **BEN CHERRY, CCIM**

Phone: 314.647.6611 ext. 113
Eddie@ManorRealEstate.com

Phone: 314.647.6611 ext. 115
Ben@ManorRealEstate.com

295 N. LINDBERGH BLVD.
 ST. LOUIS, MO 63141
 13,680 S.F. | \$2,200,000 (\$160/S.F.)
 1.43 ACRES

AERIAL



SCAN HERE!



EDDIE CHERRY, CCIM **BEN CHERRY, CCIM**

Phone: 314.647.6611 ext. 113
 Eddie@ManorRealEstate.com

Phone: 314.647.6611 ext. 115
 Ben@ManorRealEstate.com

295 N. LINDBERGH BLVD.
ST. LOUIS, MO 63141
13,680 S.F. | \$2,200,000 (\$160/S.F.)
1.43 ACRES

Information is from appropriate sources but is not guaranteed. No representation is made of environmental or other conditions of the property. We recommend Purchaser investigate fully.