



**PROMINENT 7,300 S.F.
RETAIL ENDCAP**

SCAN HERE!



EDDIE CHERRY

Phone: 314.647.6611 ext. 113
Eddie@ManorRealEstate.com

**10895 WEST FLORISSANT AVENUE
ST. LOUIS, MO 63136
7,300 S.F. RETAIL ENDCAP AVAILABLE**

PROPERTY INFORMATION



- **PROMINENT 7,300 S.F. ENDCAP SPACE AVAILABLE FOR LEASE**
- **JOIN RECENTLY OPENED BURLINGTON COAT & FIVE BELOW**
- **EXCELLENT FRONTAGE TO THE INTERSECTION OF WEST FLORISSANT & I-270**
- **MONUMENT AND STOREFRONT SIGNAGE ALONG WEST FLORISSANT & I-270**
- **ABUNDANT PARKING (4.70 PER 1,000 S.F.)**
- **MAJOR IMPROVEMENTS NEARING COMPLETION TO WEST FLORISSANT INTERCHANGE**
- **AREA RETAILERS INCLUDE WALMART, SAM'S CLUB, HARBOR FREIGHT & MORE**
- **IMMEDIATE PROXIMITY TO ST. LOUIS COMMUNITY COLLEGE**

DEMOGRAPHICS

		1 MILE	3 MILES	5 MILES
POPULATION		8,296	101,422	249,198
HOUSEHOLDS		3,559	39,269	97,796
AVERAGE HH INCOME		\$60,858	\$60,966	\$60,946

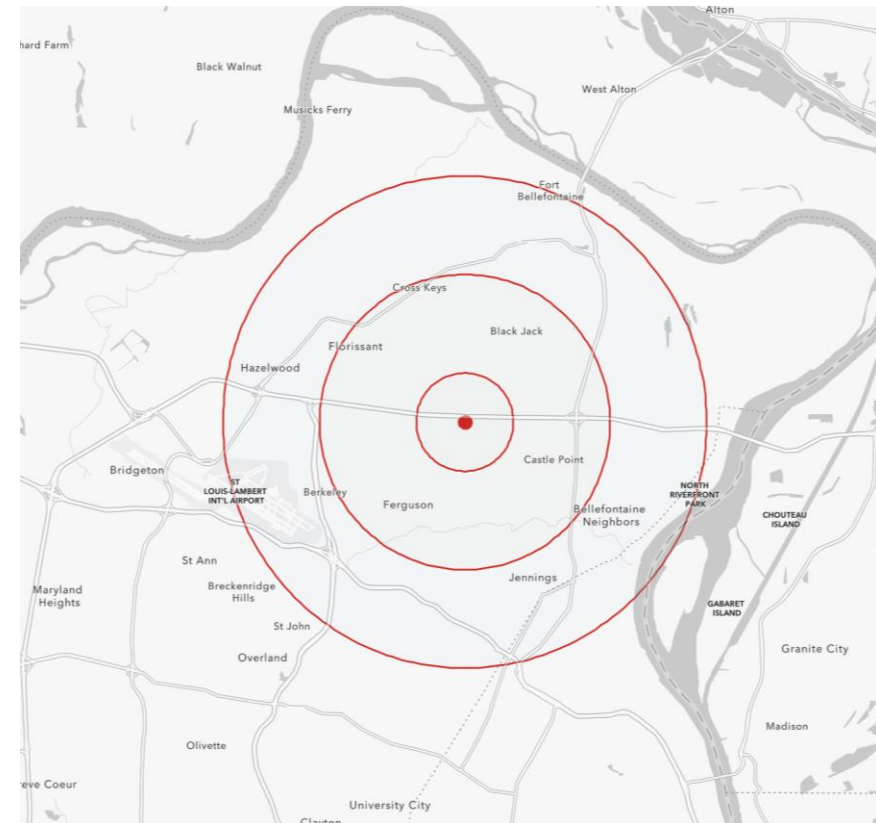

SCAN HERE!



EDDIE CHERRY

Phone: 314.647.6611 ext. 113
Eddie@ManorRealEstate.com

**10895 WEST FLORISSANT AVENUE
ST. LOUIS, MO 63136
7,300 S.F. RETAIL ENDCAP AVAILABLE**

STOREFRONT



FLOOR PLAN

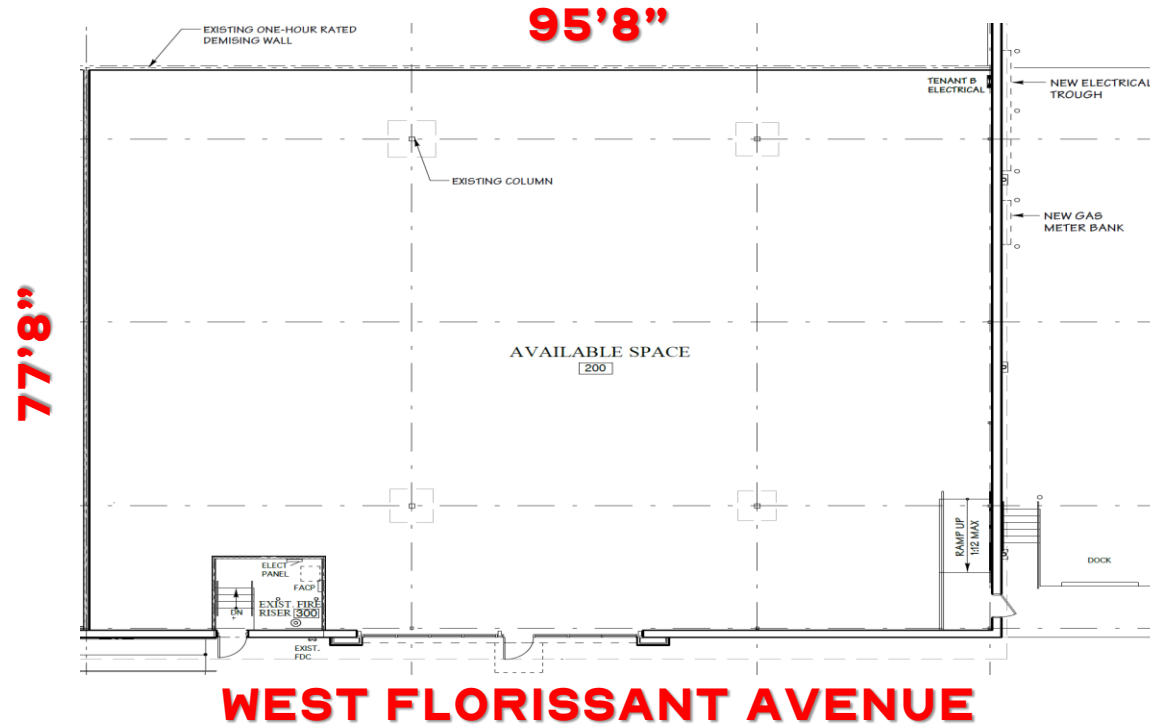

SCAN HERE!



EDDIE CHERRY

Phone: 314.647.6611 ext. 113
Eddie@ManorRealEstate.com

10895 WEST FLORISSANT AVENUE
ST. LOUIS, MO 63136
7,300 S.F. RETAIL ENDCAP AVAILABLE

AERIAL

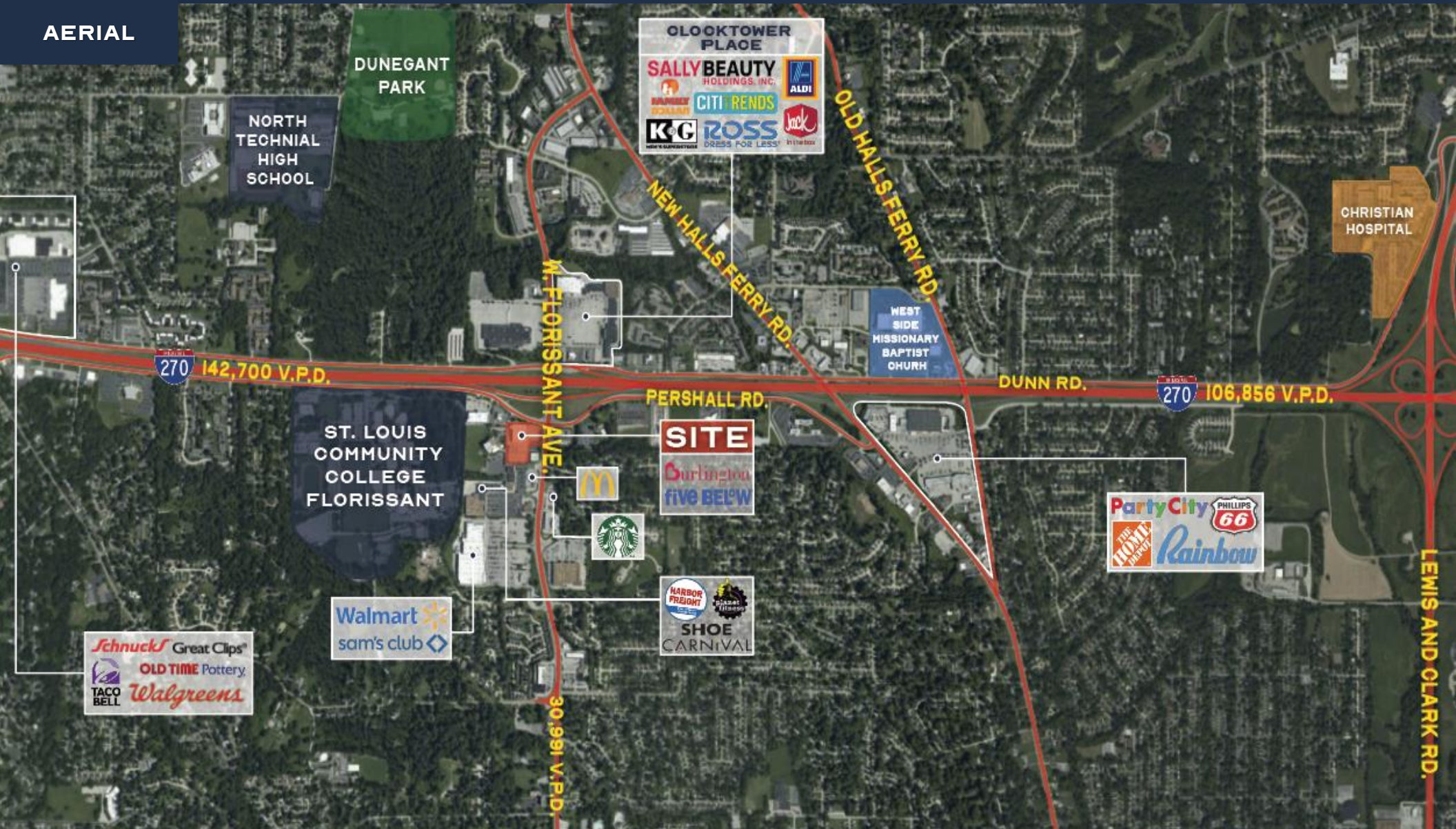

SCAN HERE!



EDDIE CHERRY

Phone: 314.647.6611 ext. 113
Eddie@ManorRealEstate.com

**10895 WEST FLORISSANT AVENUE
ST. LOUIS, MO 63136
7,300 S.F. RETAIL ENDCAP AVAILABLE**