

FOR LEASE

Shaw Retail Space



\$12/S.F. M.G. | 350-3,500 Square Feet

**4100 Shaw Boulevard
St. Louis, MO 63110**

- Large, Open 1st Floor Retail Space & Adjoining Vacant Lot
- Less than 0.6 Mile West of S Grand Blvd on Shaw Blvd
- Street Parking Available

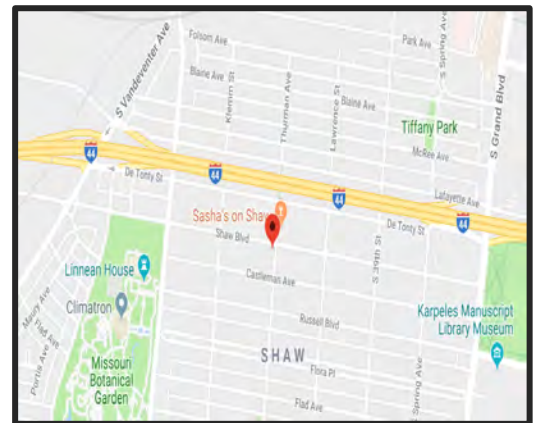

For more information on this property, please contact:

Mark Clarkson | (314) 647-6611 x127 | MClarkson@ManorRealEstate.com
Ben Cherry, CCIM | (314) 647-6611 x115 | Ben@ManorRealEstate.com

FOR LEASE

Shaw Retail Space



\$12/S.F. M.G. | 350-3,500 Square Feet

- Built in 1915
- Raw Space without HVAC
- Zoned "F" – Neighborhood Commercial
- Located on the Hard Corner of Shaw Blvd and Thurman Ave
- Surrounded by high density residential neighborhood
- Open Lot directly adjacent to the building is included
- Caddy Corner to Sasha's on Shaw
- Tenant is responsible For Gas, Electric, Water, and Sewer Utilities
- Convenient Access to I-64 (<1 mi) and I-44 (<0.4 mi), I-100 (0.85 mi)



For more information on this property, please contact:

Mark Clarkson | (314) 647-6611 x127 | MClarkson@ManorRealEstate.com
Ben Cherry, CCIM | (314) 647-6611 x115 | Ben@ManorRealEstate.com

FOR LEASE

Shaw Retail Space

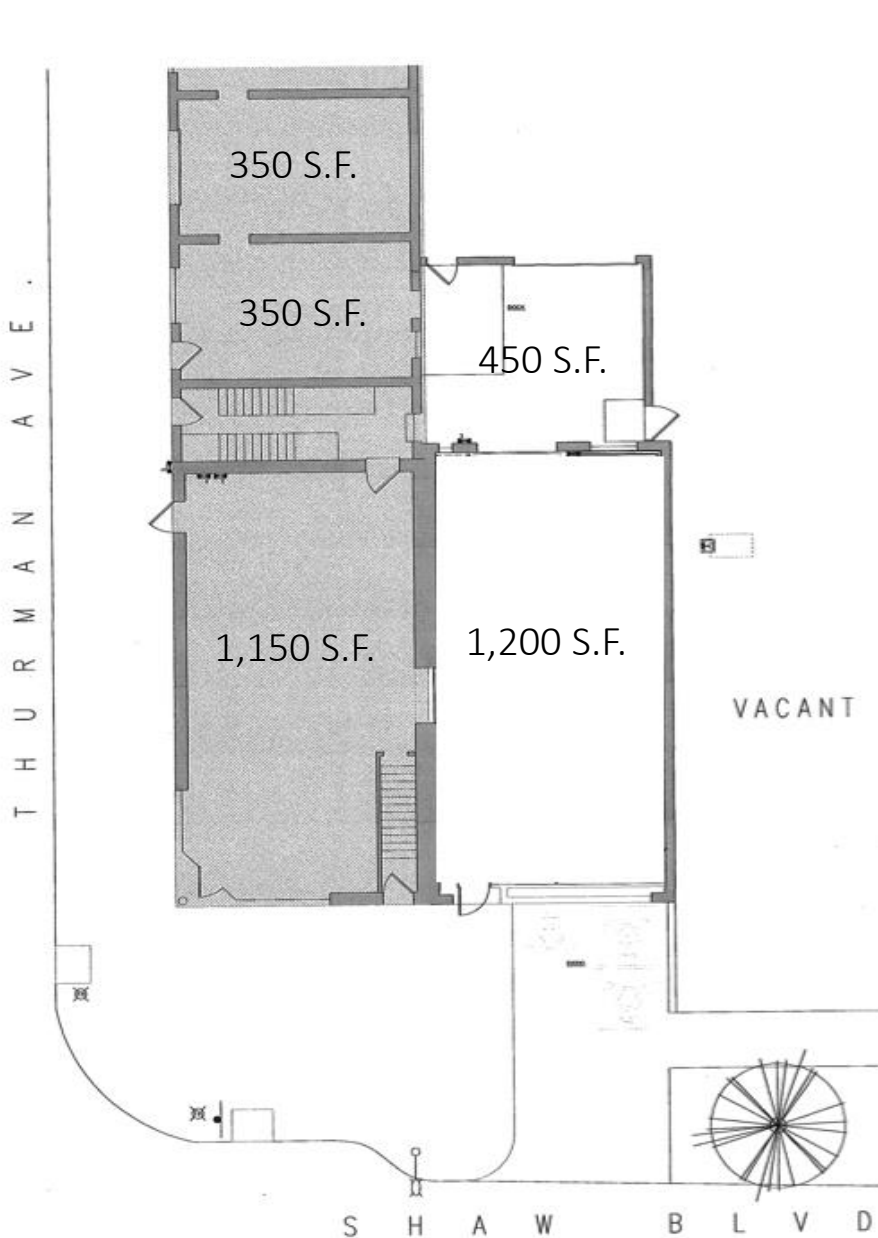

For more information on this property, please contact:

Mark Clarkson | (314) 647-6611 x127 | MClarkson@ManorRealEstate.com

Ben Cherry, CCIM | (314) 647-6611 x115 | Ben@ManorRealEstate.com